

- 1
- 2
- 3
- 4
- 5
- 6
- 7
- 8
- 9
- 10
- 11
- 12
- 13
- 14
- 15
- 16
- 17
- 18

MATERIAL

Aluminium, matte finish.
AISI 304 stainless steel screws and nuts.

STANDARD EXECUTIONS

Surface finish index:
- **BL**: natural colour.
- **SW**: epoxy resin coating resistant to UV rays, RAL 9005 black colour.

FEATURES AND APPLICATIONS

The assembly hole of GN 163 connecting clamps allows an excellent match with tubes GN 990 (see page 1368).

The clamping screw d3 may be replaced by clamping kit GN 911 (see page 1372).

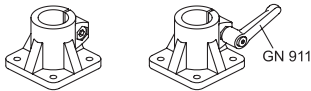

Conversion Table	
1 mm = 0.039 inch	
d1	
mm	inch
20	0.78
25	0.98
30	1.17
32	1.25
35	1.37
40	1.56
42	1.64
45	1.76
48	1.87
50	1.95
60	2.34

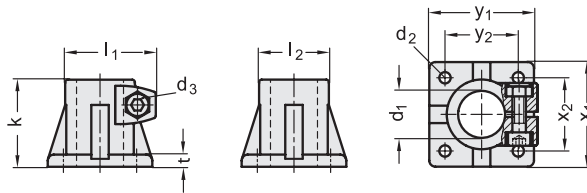

METRIC

Code BL	Code SW	Description	d1	d2	d3	k	l1	l2	t	x1	x2	y1	y2	d3 Clamping kit	Δ
GN.48411	GN.48416	GN 163-B20-50-2-*	20	6.5	M8	50	52	40	7	60	42	60	42	GN 911-M8-32	199
GN.48431	GN.48436	GN 163-B25-50-2-*	25	6.5	M8	50	52	40	7	60	42	60	42	GN 911-M8-32	176
GN.48451	GN.48456	GN 163-B30-50-2-*	30	6.5	M8	50	52	40	7	60	42	60	42	GN 911-M8-32	149
GN.48471	GN.48476	GN 163-B30-70-2-*	30	8.5	M10	70	68	56	10	90	64	90	64	GN 911-M10-40	530
GN.48491	GN.48496	GN 163-B32-70-2-*	32	8.5	M10	70	68	56	10	90	64	90	64	GN 911-M10-40	505
GN.48511	GN.48516	GN 163-B35-70-2-*	35	8.5	M10	70	68	56	10	90	64	90	64	GN 911-M10-40	484
GN.48531	GN.48536	GN 163-B40-70-2-*	40	8.5	M10	70	68	56	10	90	64	90	64	GN 911-M10-40	437
GN.48551	GN.48556	GN 163-B40-85-2-*	40	11	M10	85	77.5	65	14	105	74	105	74	GN 911-M10-55	850
GN.48571	GN.48576	GN 163-B42-85-2-*	42	11	M10	85	77.5	65	14	105	74	105	74	GN 911-M10-55	829
GN.48591	GN.48596	GN 163-B45-85-2-*	45	11	M10	85	77.5	65	14	105	74	105	74	GN 911-M10-55	775
GN.48611	GN.48616	GN 163-B48-85-2-*	48	11	M10	85	77.5	65	14	105	74	105	74	GN 911-M10-55	740
GN.48631	GN.48636	GN 163-B50-85-2-*	50	11	M10	85	77.5	65	14	105	74	105	74	GN 911-M10-55	710
GN.48671	GN.48676	GN 163-B60-100-2-*	60	11	M10	100	92	80	14	125	89	125	89	GN 911-M10-55	710

Connecting clamps

* Complete the description of the standard item needed by adding the finish of the connector clamps: BL (blank) or SW (black).